

Wall-mounted cooling units

Cool Efficiency, useful cooling output 1000/2000 W

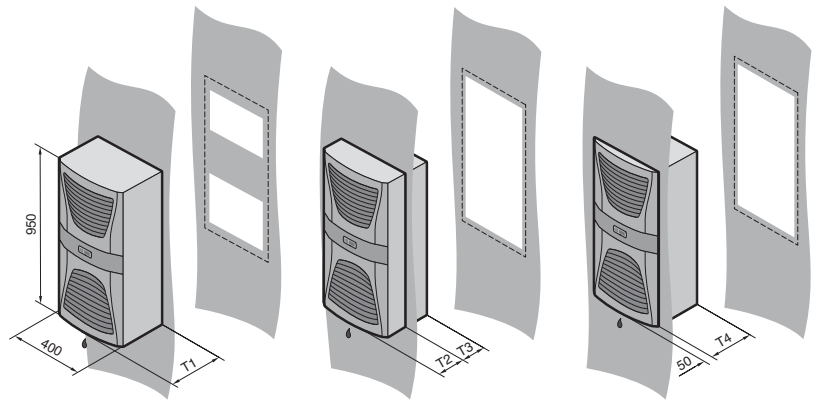

B = Width
T = Depth

Supply includes:

Nano-coated condenser and integral electronic condensate evaporation. Fully wired ready for connection, including drilling template and assembly parts.

Detailed drawing,
see page 184.



Model No. SK with Comfort controller, RAL 7035	3304.800	3328.800
Rated operating voltage V, Hz	230, 1~, 50	230, 1~, 50
Dimensions in mm	B 400	400
	H 950	1580
	T1 260	295
	T2 155	150
	T3 105	145
	T4 210	245
Useful cooling output \dot{Q}_K to DIN 3168	L 35 L 35 1000 W	2000 W

Rated current max.		3.0 A	4.5 A
Start-up current		12.0 A	12.0 A
Pre-fuse T		10.0 A	10.0 A
Power consumption P_{el} to DIN 3168	L 35 L 35	520 W	780 W
	L 35 L 45	580 W	870 W
Refrigeration factor $\varepsilon = \dot{Q}_K/P_{el}$	L 35 L 35	1.9	2.6
Refrigerant		R134a, 500 g	R134a, 750 g
Permissible operating pressure p. max.		25 bar	28 bar
Temperature and setting range		+20°C to +45°C	
Protection category to EN 60 529	External circuit	IP 34	
	Internal circuit	IP 54	
Duty cycle		100%	
Type of connection		Plug-in terminal strip	
Weight		40 kg	66 kg
Air throughput of fans	External circuit	600 m³/h	
	Internal circuit	450 m³/h	
Temperature control		Comfort controller (factory setting +35°C)	

Accessories	Packs of	SK Cat. (hardcover), page
Filter mats	3 3286.400	189
Metal filters	1 3286.410	190
Door-operated switch	1 4127.000	176
SK bus system for Comfort controller	1 3124.100	180
RiDiag II including cables for Comfort controller	1 3159.100	195
Interface card for Comfort controller	1 3124.200	179
Condensate hose	1 3301.612	192

Delivery times on request.

Special voltages and other output categories available on request. Technical modifications reserved.

Wall-mounted cooling units